

VALENA LIFE/ALLURE

TRANSFORM
YOUR DAILY LIFE



Valena Life



Lightness at the service of your touch

The modern concave rocker.



The light side of slimness

The back gives the impression
that the product is floating
on the wall.



Valena Allure



Step out of the ordinary

Valena Allure: innovative design
can transform the home into an
area of new experiences.



The light

An integrated, subtle and
sophisticated light option under
the switch allows users to easily
locate it even in the dark and give
the ambience a technological touch.



Valena Life/Allure finishes

Forever Classic

Simple, subtle, suitable for all interiors. And a true classic with a sleek look and just a hint of mystery.



WHITE



WHITE



IVORY

Aluminium Touch

Modern, refined, a minimalist style with maximum visual impact. And a collection that pairs rounded lines and curved relief.



ALUMINIUM



ALUMINIUM



STAINLESS STEEL

Modern Black

Elegant and sophisticated, black infiltrates our interiors. The black finish gives character and adds a decorative touch.



MATT BLACK



MATT BLACK



GRAPHITE

Pop Tonic

Stimulating colours and prints of natural materials. Soft curves with organic prints that let you fully express your fantasy.



LIME



TERRACOTTA



ADRIA

Precious Style

Precious materials, including real marble, with an impeccable finish. A refined choice to express your taste.



PALACE MARBLE



WHITE MIRROR



WHITE GLASS



IVORY



PEARL



PEARL



INOX STYLE



DARK STAINLESS
STEEL



DARK WOOD



WALNUT



COPPER STYLE



LEATHER



LIGHT WOOD



NARCIS CHROME



NARCIS GOLD

MyHOME_Up

Home automation evolution

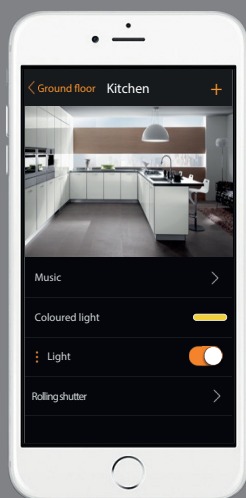

MyHOME_Up App



MyHOME_Up is the integrated modular home automation system based on the BUS technology with 2 wires pair that offers smart solutions in terms of:

- **comfort**, thanks to the custom setting of lights, shutters, temperature and music in every room.
- **safety** to prevent unwanted intrusions.
- **control of consumption and power levels** for energy and cost savings and to avoid overload black-outs.

MyHOME_Up is also an open system, able to integrate with **systems and devices of other brands** to perform advanced functions.

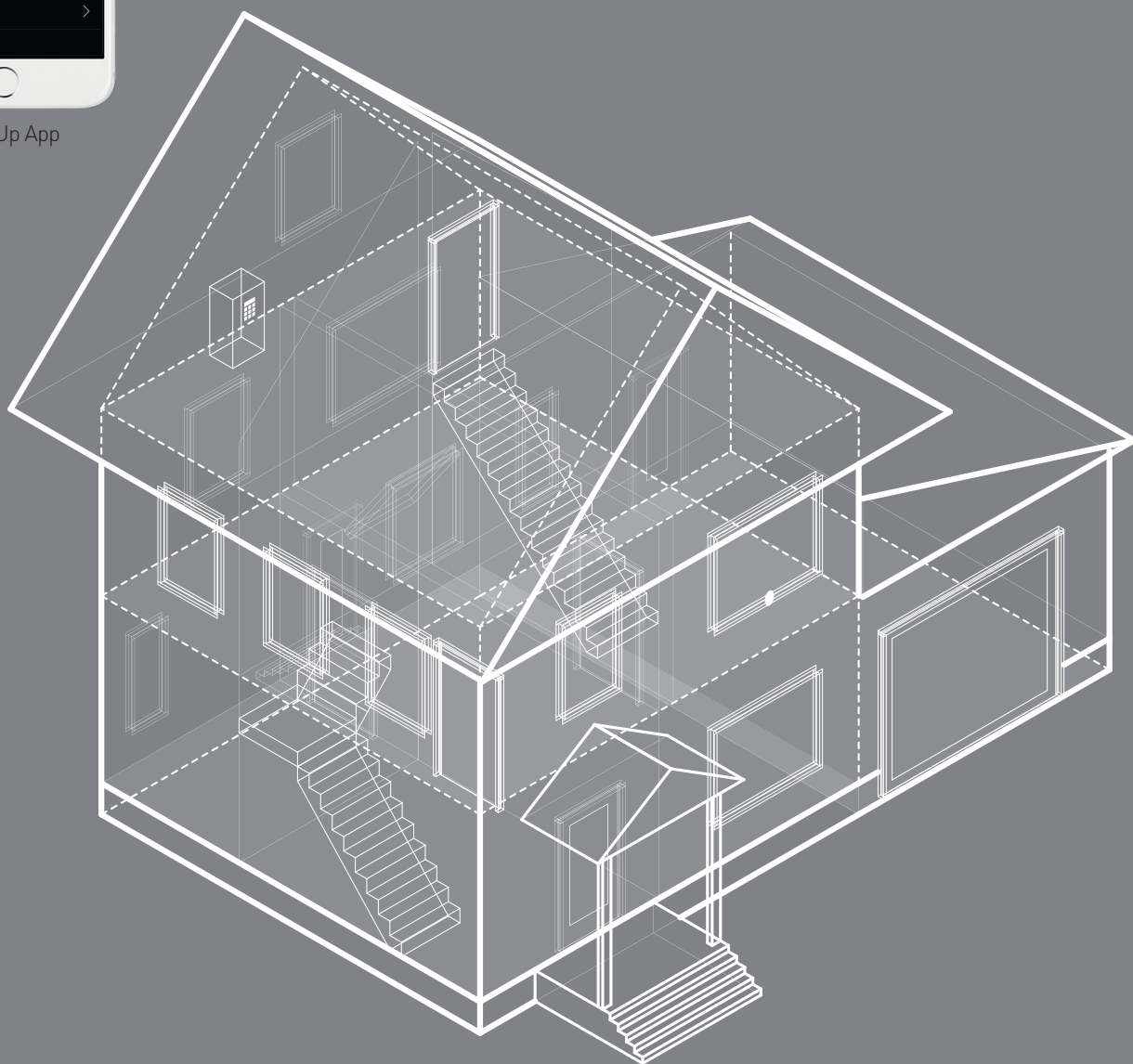

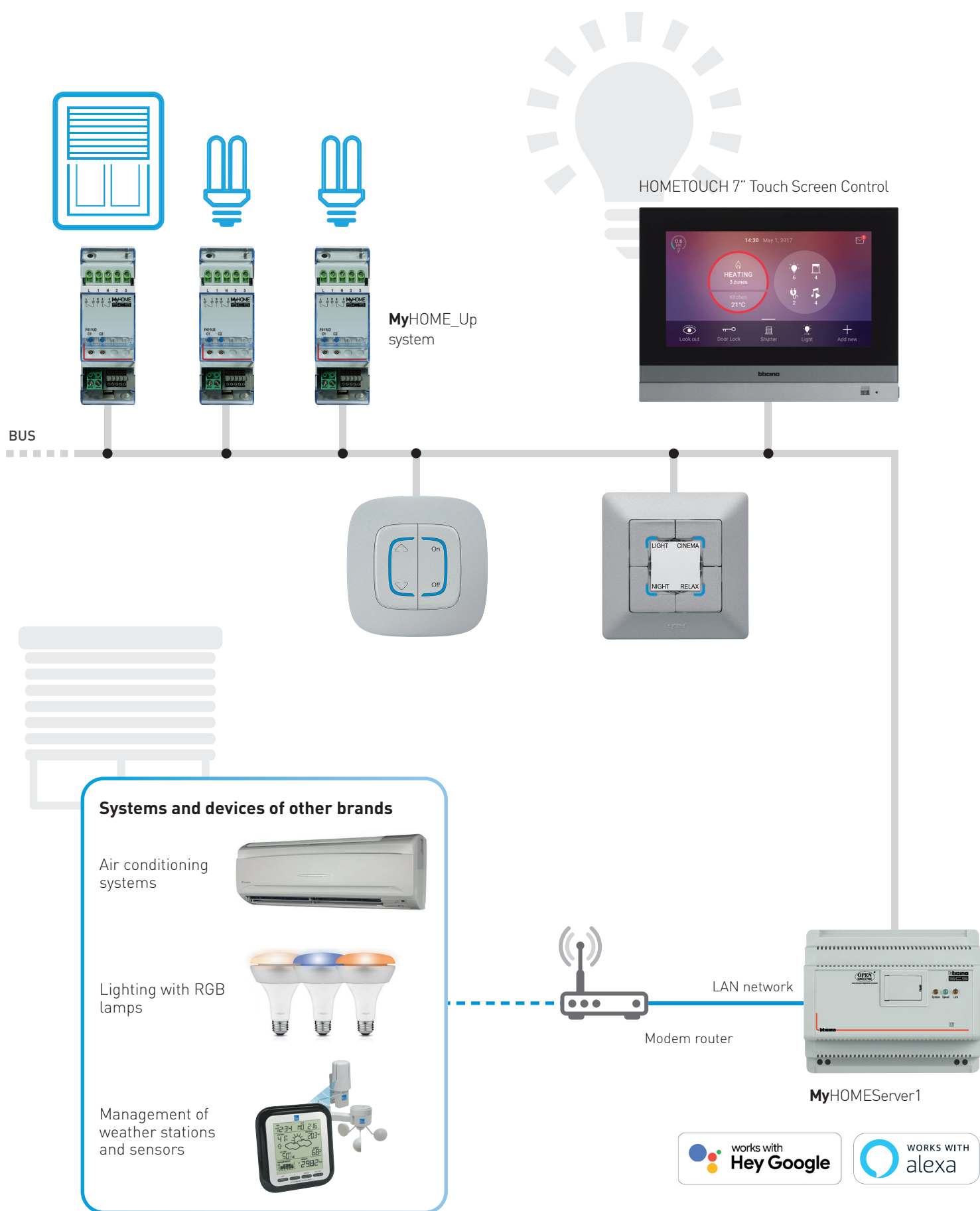

Control **MyHOME_Up** as you wish

CONTROL WITH SMARTPHONE AND **MyHOME_Up** DEDICATED APP

This is done using the specific **MyHOME_Up** App installed in the Smartphone of the user. The connection to the system takes advantage of the MyHOMEServer1 gateway connected to the home Wi-Fi network and the Internet through the modem router.

No application configuration by the user is required. All the devices to manage are in fact already recognised when the system is put into operation, which is done by the installer using the same App installed in the own Smartphone.

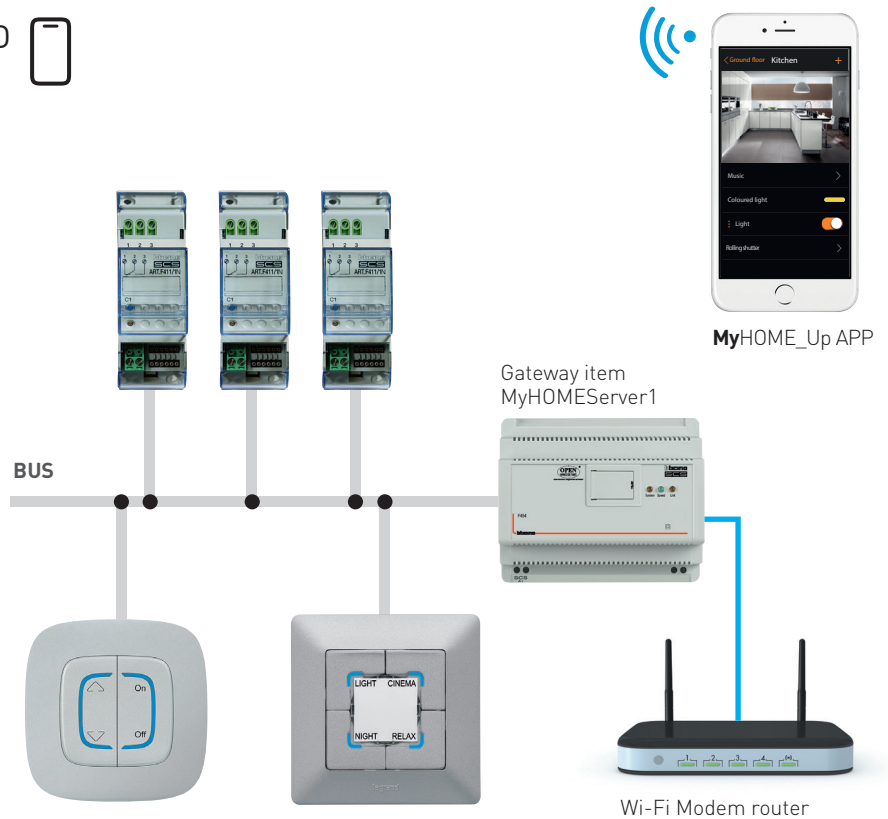

With **MyHOME_Up** application it will be possible to:

- control the lights;
- control the shutters;
- adjust the temperature;
- control the controlled socket;
- display the instantaneous consumptions of the loads (washing machine, cooker etc.);
- control the devices of other brands (LIFEX, Philips Hue lamps etc...);
- open door locks;
- listen to the music from the Nuvo multiroom sound system;
- create and manage scenarios.

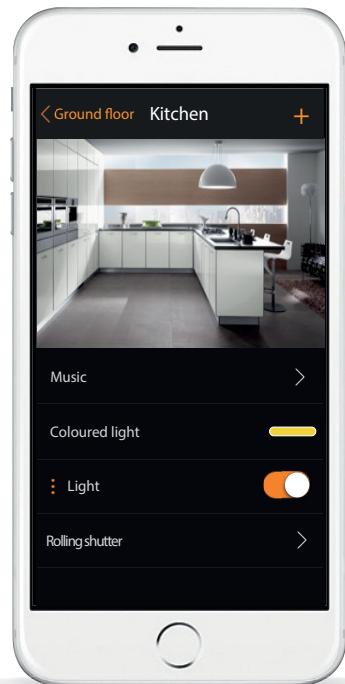

MyHOME_Up is available free for iOS devices from App Store and for Android devices from Play Store.



CONTROL WITH HOMETOUCH TOUCH SCREEN



Thanks to the simple and immediate interface, with this touch device - item 3488 (black) and item 3488W (white) -, users will have all the functions of the **MyHOME_Up** system at their fingertips:

- Lighting;
- Shutter automation;
- Temperature control;
- Nuvo multi-room sound system;
- Scenarios;
- Function possible thanks to the integration of third-party devices and systems.

In addition, HOMETOUCH also integrates the BTicino video door entry system and can be used as connected internal unit for the handling of calls both locally and from the Smartphone, using the free **DOOR ENTRY App** for HOMETOUCH.

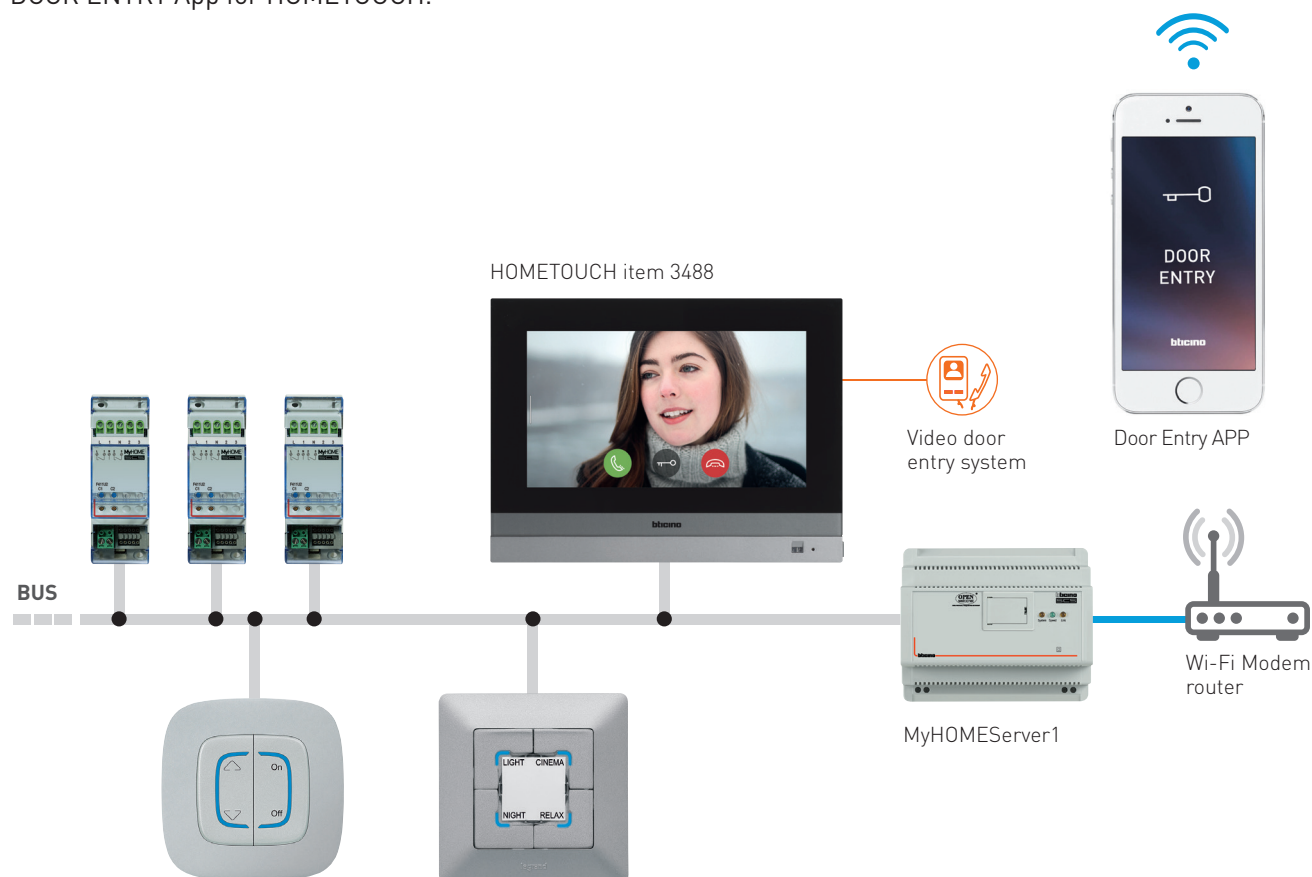

Valena™ Life/Allure - MyHOME_Up

integration and control



BT-MYHOMESERVER1

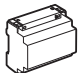
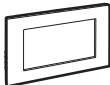
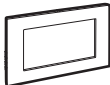
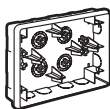
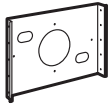
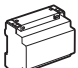

BT-3488

Pack	Cat.Nos	Control server using the app
1	BT-MYHOMESERVER1	 Server to associate devices during the system starting-up and for the local and remote management of the functions by the user with the specific MyHOME_Up application for Android and iOS smartphones or tablets
1 1	BT-3488W BT-3488	HOMETOUCH - Touch screen 7" For the management of all MyHOME_Up functions, that can be integrated with the video door entry system and with indoor and outdoor Netatmo cameras, to be used as connected internal unit. To use the home automation functions, configuration is not necessary. It is possible to display the MyHOME_Up system status and control the integrated functions (lights, automation, scenarios, burglar alarm, temperature management, Nuvo music system...). Thanks to the "DOOR ENTRY for HOMETOUCH" application, available both for Android and iOS operating systems, it is also possible to manage the video door entry functions of a BTicino 2 wires system using the 7" capacitive display or the smartphone. Flush-mounted installation with box for masonry walls (Cat.No BT-3487) or wall-mounted installation with the supplied metal bracket. <div>  White  Black/Grey </div>
1	BT-3487	Box for flush-mounted installation  Box for flush-mounted installation of the HOMETOUCH Touch screens Cat.Nos BT-3488 and BT-3488W. Width 197 mm, height 148 mm and depth 52 mm.
1	BT-3487AP	 Support for flush-mounted installation on plasterboard walls of the HOMETOUCH Touch screens Cat.Nos BT-3488 and BT-3488W.
1	BT-F459	Driver manager  Integration platform with other brand systems. 6 DIN modules.

Valena™ Life/Allure - MyHOME_Up

integration and control

MyHOME_Up App



Mobile device App that allows:

- the installer to easily associate the devices together when starting up the system, thanks to a self-learning procedure.
- the user to manage his home home-automation wherever he is.

DOOR ENTRY for HOMETOUCH App

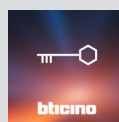

Allows the user to manage the video internal unit calls locally and remotely using the smartphone or with a simple touch open the gate, activate the cameras and the video door entry answering machine.

Valena™ Life/Allure - MyHOME_Up

Alexa Voice Control



BT-KG8013





BT-K8003



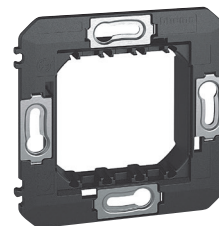

BT-KG8102P1

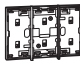

BT-K8102

Pack	Cat.Nos	Voice control
1 1 1	BT-KW8013 BT-KG8013 BT-KM8013	Amazon Alexa digital control device with voice assistant, including two touch controls for lighting management 27 V= power supply from BUS through connection module Cat.No BT-KW8001 or additional power supply unit Cat.No BT-K8003 3 modules  White Black Sand
1	BT-K8003	Connection module with additional power supply dedicated to voice control devices Cat.Nos BT-KW8013, BT-KG8013 and BT-KM8013 2 modules White 

Pack	Cat.Nos	Electrified frame for 2-module box
1 1 1	BT-KW8102P1 BT-KG8102P1 BT-KM8102P1	Electrified frame with intermediate control separators (removable) for installing up to 3 digital controls in a 2-module box, with support Cat.No BT-K8102  White Black Sand
1	BT-K8102	Support for 2-module box  Support for installing electrified frames Cat.Nos BT-KW8102P1, BT-KG8102P1 and BT-KM8102P1 in a 2-module box White

Valena™ Life/Allure - MyHOME_Up

lighting control and automation mechanisms





0 675 52

7 521 82 + 7 540 01

To be equipped with cover plates (p.45-46), support frame (Cat.No 7 520 44) and plates (p.34-35)
To be installed in flush-mounting boxes

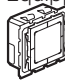
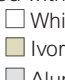
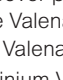
Pack	Cat.Nos	Micropush control mechanisms
1	0 675 52	2 modules Basic control For controlling 1 or 2 controllers (eg.: lighting, shutters, lighting+shutters) depending on the selected configuration Used to manage groups of functions and centralize them (scenario switch type)
1	0 675 53	Multifunction control For controlling 1 or 2 controllers (eg.: ON/OFF, dimming, shutters, sound system, door release) depending on the selected configuration Can control up to 4 scenarios
5	7 520 44	In'matic support for MyHOME mechanisms Accepts 2-module mechanisms
1	0 675 61	Flush-mounting controller with built-in control For controlling two lighting circuits or a blind motor Slat orientation control 2 outputs - 2 A 230 V power supply with neutral connection

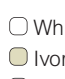
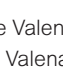
Pack	Cat.Nos	Advanced roller shutter management devices
1	0 675 57	Relay interlocking or pulse based motor drive Position status return: closed, open, intermediate position. Drive following different orders: up, down, or opening Controller with integrated control for driving a motor To be equipped with cover plates: - shutter STOP marking - up/down symbol Maximum motor power: 500 W Logic relay interlocking Stop, up, down function Possibility of blade angle adjustment Recall of a previously saved opening/closing position Recording of the opening/closing position on the control using self-learning procedure 2 modules
1	0 675 58	Specific advanced motor management control To be equipped with cover plates: - shutter STOP marking - up/down symbol Point-point, room, group, and general control of the motorised roller shutters, to be used in conjunction with actuators Cat.Nos BT-F401 or 0 675 57 Stop, up, down function Possibility of blade angle adjustment Recall of a previously saved opening/closing position Recording of the opening/closing position on the control using self-learning procedure 2 modules
1	7 521 82	Scenario controllers For controlling a number of controllers and managing 4 scenarios Supplied complete with scenario identification label Equipped with cover plates  White Valena Life  Ivory Valena Life  Aluminium Valena Life  White Valena Allure  Ivory Valena Allure  Aluminium Valena Allure
1	7 522 82	
1	7 523 82	
1	7 527 82	
1	7 528 82	
1	7 529 82	

 Four pieces required for a complete product

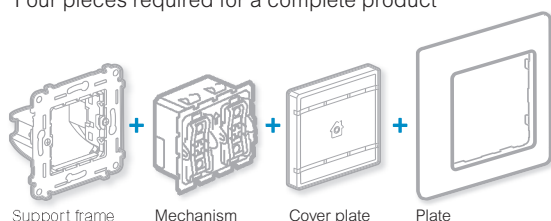

Valena™ Life/Allure - MyHOME_Up

modular equipment for lighting control and automation

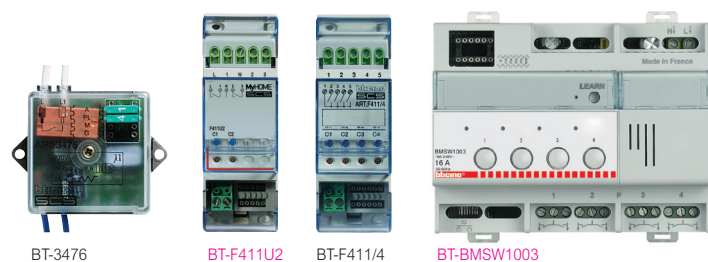

Pack	Cat.Nos	Contact interfaces
1	BT-3477	Control interfaces with 2 independent contacts for the control of 2 actuators for single function loads, or 1 actuator for double function loads (shutters) Inputs accept two traditional switches or push-buttons with NO and NC contact, or a traditional two-way switch, or interlocked push-buttons To be installed in flush-mounting box
1	BT-F428	2 DIN modules 17.5 mm
1	BT-3476	Light control/actuator 1 relay actuator - for single loads: 2 A resistive or incandescence lamps, 2 A cos Φ 0.5 for ferromagnetic transformers Traditional push-button with NO contact accepted in input
1	BT-F411U2	Actuators for centralisations Actuator with 2 independent relays For single and double loads: 10 A resistive and 6 A incandescence lamps, 500 W for reducer motors, 2 A cos Φ 0.5 for ferromagnetic transformers and 250 W for fluorescent lamps Logic relay interlock via configuration "Zero crossing" technology 2 DIN modules
1	BT-F411/4	Actuator with 4 independent relays For single, double or mixed loads: 2 A resistive, 2 A incandescence lamps, 500 W for reducer motors, 2 A cos Φ 0,5 for ferromagnetic transformers and 70 W for fluorescent lamps Logic relay interlock via configuration 2 DIN modules
1	BT-BMSW1003	ON/OFF actuator, 4 independent outputs with maximum load 16 A at 230 V~. Clamp connection and RJ 45. IP20 protection index Power supply 100/240 V~ 50/60 Hz Push-buttons for load direct control "Zero crossing" technology 6 DIN modules
1	BT-BMSW1005	ON/OFF actuator, 8 independent outputs with maximum load 16 A at 230 V~. Clamp connection. IP20 protection index Power supply 100/240 V~ 50/60 Hz Push- buttons for load direct control "Zero Crossing" technology 10 DIN modules
1	BT-F401	Actuator with 2 internal relays and 4 pushbuttons In addition to monostable and bistable UP/DOWN operation, the actuator also places the shutter in a stored (PRESET) position 2 DIN modules

Valena™ Life/Allure - MyHOME_Up

modular equipment for lighting control and automation

■ Lighting and automation actuators

Loads that can be driven (250 V~ 50/60 Hz)

Cat.No.	Energy saving incandescence and halogen lamps	LED lamps	Linear fluorescent lamps ⁽¹⁾	Compact fluorescent lamps
BT-3476	2 A 460 W	40 W Max 1 lamp	-	40 W Max 1 lamp
BT-F411U2	10 A 1380 W	250 W Max 4 lamps	4 A 230 W	250 W Max 4 lamps
BT-F411/4	2 A 460 W	70 W Max 2 lamps	0.3 A 70 W	70 W Max 2 lamps
BT-BMSW1003	16 A 3680 W	2.1 A 500 VA	10 x (2 x 36 W) 4.3 A	1150 W 5 A
BT-BMSW1005	16 A 3680 W	2.1 A 500 VA	10 x (2 x 36 W) 4.3 A	5 A 1150 VA

Cat.No.	Electronic transformers ⁽²⁾	Ferromagnetic transformers ⁽²⁾⁽³⁾	Reducer motors for shutters ⁽⁴⁾
BT-3476	-	2 A cos Φ 0.5 460 VA	-
BT-F411U2	4 A 230 W	4 A cos Φ 0.5 460 VA	2 A 460 W
BT-F411/4	0.3 A 70 W	2 A cos Φ 0.5 460 VA	2 A 460 W
BT-BMSW1003	16 A 3680 W	16 A 3680 W	-
BT-BMSW1005	16 A 3680 W	16 A 3680 W	-
BT-F401	-	-	2 A 250 VAC

1: Power factor corrected fluorescent lamps, discharge lamps.

2: The transformer must be loaded at its rated power and however never less than 90% of this power. It is preferable to use a single transformer rather than several transformers in parallel. For example it is better to use a single 250 VA transformer with five 50W spotlights connected rather than use five 50 VA transformers in parallel each with a 50 W spotlight.

3: Account must be taken of the transformer yield to calculate the effective power of the load connected to the actuator. For example if a dimmer is connected to a 100 VA ferromagnetic transformer with yield 0.8, the effective power of the load will be 125 VA.

4: The symbol on the actuators refers to the shutter reducer motors.

Valena™ Life/Allure - MyHOME_Up

modular equipment for lighting control and automation (continued)





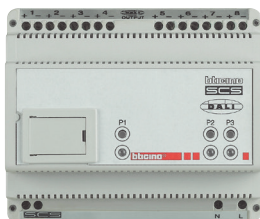



BT-F413N



BT-F429



BT-F418U2

Pack	Cat.Nos	Dimmers for centralisations
1	BT-F413N	 1-output dimmer to supply fluorescent lamps or LED sources with input 1-10 V for single loads up to 2.5 A at 230 V~ Screw connection. Power supply 27 V~. Absorption 30 mA Max 10 ballast can be connected (clamps 1-2) With push-button for load direct control Version for fastening on DIN rail 2 modules
1	BT-BMDI1002	 1/10V dimmer 4 outputs with maximum load 4.3 A at 230 V~ Clamp connection. IP20 protection index. Power supply 100/240 V~ 50/60 Hz Push-buttons for load direct control "Zero Crossing" technology 10 DIN modules
1	BT-F429	 DALI dimmer with 8 independent outputs for the connection of up to 16 DALI reactors for each output 230 V~ power supply 50/60 Hz ; 110 - 240 V~ Absorption 5 mA With push-button for load direct control Version for fastening on DIN rail 6 modules
1	BT-F416U1	 Multi-load dimmer, 1 output with maximum load 4.3 A at 230 V~ Clamp connection and RJ45 IP20 protection index Power supply 100/240 V~ 50/60 Hz Push-button for load direct control 6 DIN modules
1	BT-F418U2	 Two-channel dimmer for the management of dimmer LEDs, dimmer compact fluorescent lamps (CFL), energy saving halogen lamps and electronic transformers at 110-230 V Possibility of parallelisation of the two channels to increase the maximum power which can be managed Power supply 27 V~ Absorption 18 mA Version for fastening on DIN rail 4 modules
Additional DIN devices		
1	BT-F425	 Memory module for actuators Restore the last state of an actuator in the event of a power failure
1	BT-F422	 SCS-SCS gateway (extension) Allows extension of the installation or integration of different functions Suitable for larger installations

Valena™ Life/Allure - MyHOME_Up

modular equipment for lighting control and automation (continued)

Dimmers for centralisations

Loads that can be driven (250 V~ 50/60 Hz)

Cat.No.	Energy saving incandescence and halogen lamps	LED lamps	Linear fluorescent lamps ⁽¹⁾	Compact fluorescent lamps
BT-F413N	-	-	2 A 460 W ⁽²⁾ Max 10 ballast - type T5, T8 - compact or driver for LED	-
BT-BMDI1002	Dimmer for ballast 4 x 4.3 A outputs - 4 x 1000 VA at 230 VAC			
BT-F429	SCS/DALI dimmer interface - 8 x 16 ballast			
BT-F416U1	4.3 A 40 - 1000 W	-	-	-
BT-F418U2	2 x 300 W	2 x 300 VA	-	2 x 300 VA

Cat.No.	Electronic transformers ⁽²⁾	Ferromagnetic transformers ⁽²⁾⁽³⁾	Reducer motors for shutters ⁽⁴⁾
BT-BMDI1002	Dimmer for ballast 4 x 4.3 A outputs - 4 x 1000 VA at 230 VAC		
BT-F429	SCS/DALI dimmer interface - 8 x 16 ballast		
BT-F416U1	4.3 A 40 - 1000 W	4.3 A 40 - 1000 W	-
BT-F418U2	2 x 300 W	2 x 300 VA	-

1: Power factor corrected fluorescent lamps, discharge lamps.

2: Only compatible with lamps with 1/10 V ballast.

3: The transformer must be loaded at its rated power and however never less than 90% of this power. It is preferable to use a single transformer rather than several transformers in parallel. For example it is better to use a single 250 VA transformer with five 50W spotlights connected rather than use five 50 VA transformers in parallel each with a 50 W spotlight.

4: Account must be taken of the transformer yield to calculate the effective power of the load connected to the actuator. For example if a dimmer is connected to a 100 VA ferromagnetic transformer with yield 0.8, the effective power of the load will be 125 VA.

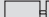
5: The  symbol on the actuators refers to the shutter reducer motors.

Valena™ Life/Allure - MyHOME_Up

sensors



BT-BMSE3003



0 672 26



BT-BMSO4001



BT-BMSO4003



0 488 75

Pack	Cat.Nos	Lighting/movement sensors	Pack	Cat.Nos	180° dual technology presence sensor
1	BT-BMSE3001	<p>Ceiling flush-mounting installation using springs or installation boxes</p> <p>Surface-mounting installation using surface installation box Cat.No 0 488 75</p> <p>Maximum installation height: 6 m</p> <p>Coverage angles (v/h): 90/360°</p> <p>IP20 protection index</p> <p>RJ 45 clamp connection</p> <p>Operation types: Auto / Eco / Walk through</p> <p>Regulation, with basic/advanced remote control (Cat.Nos BT-BMSO4003 and BT-BMSO4001) or through configuration software, of:</p> <ul style="list-style-type: none"> - the lighting level, from 5 to 1275 lux - the time delay, from 30 s to 255 h - the main operating parameters <p>Push&Learn push-button</p> <p> PIR SCS sensor for detection of movement and lighting level</p> <p>Range 8 m (50 m²) for an installation height of 2.5 m</p> <p>27 V_~ power supply from BUS</p> <p>Absorption 12 mA</p>	1	0 672 26	<p> ECO</p> <p>Dual technology presence sensor</p> <p> Automatic dual technology (IR & Ultrasonic) presence sensor with adjustable light level and time-delay before switch-off</p> <p>Equipped with a push-button</p> <p>Range 8 m for an installation height of 1.2 m</p> <p>IP41</p> <p>Standby consumption: 0.5 W</p> <p>To be equipped with support frame (Cat.No 7 520 44) and plate (p.34-35)</p> <p>2 modules</p> <p>Cover plates for dual technology presence sensor</p> <p> <input type="checkbox"/> White Valena Life</p> <p> <input type="checkbox"/> Ivory Valena Life</p> <p> <input type="checkbox"/> Aluminium Valena Life</p> <p> <input type="checkbox"/> White Valena Allure</p> <p> <input type="checkbox"/> Ivory Valena Allure</p> <p> <input type="checkbox"/> Aluminium Valena Allure</p>
1	BT-BMSE3003	<p> Double technology SCS sensor: passive infrared for the detection of presence and the lighting level</p> <p>IR range 8 m (50 m²) and Ultrasonic range 11 m (95 m²) for an installation height of 2.5 m</p> <p>27 V_~ power supply from BUS</p> <p>Absorption 17 mA</p>	1	7 549 20	
			1	7 549 21	
			1	7 549 22	
			1	7 549 25	
			1	7 549 26	
			1	7 549 27	
					Configuration remote controls
					To be used to adjust the main operating parameters of compatible sensors
			1	BT-BMSO4001	Advanced configuration remote control
					With IR transmitter and receiver
					With display for the acquisition of the parameters set on the sensors and to modify them
					Battery charging via USB mini port
			1	BT-BMSO4003	Basic configuration remote control
					With IR transmitter
					Modification of parameters only possible for preset values
					Battery charging not available
					Installation accessory
			1	0 488 75	Ceiling-mounting box compatible with sensors Cat.Nos BT-BMSE3001 and BT-BMSE3003
					IP20 protection index
					Dimensions: Ø 100 x 50 mm
1	0 672 25	<p> PIR motion sensor</p> <p>Automatic passive infrared motion sensor with adjustable light level and time-delay before switch-off</p> <p>Range 8 m for an installation height of 1.2 m</p> <p>IP41</p> <p>Standby consumption: 0.3 W</p> <p>To be equipped with support frame (Cat.No 7 520 44) and plate (p.34-35)</p> <p>2 modules</p> <p>Cover plates for PIR motion sensor</p> <p> <input type="checkbox"/> White Valena Life</p> <p> <input type="checkbox"/> Ivory Valena Life</p> <p> <input type="checkbox"/> Aluminium Valena Life</p> <p> <input type="checkbox"/> White Valena Allure</p> <p> <input type="checkbox"/> Ivory Valena Allure</p> <p> <input type="checkbox"/> Aluminium Valena Allure</p>			
1	7 548 84				
1	7 548 93				
1	7 548 94				
1	7 549 03				
1	7 549 04				
1	7 549 13				

Valena™ Life/Allure - MyHOME_Up

temperature control mechanisms



7 521 31 + 7 541 31



BT-3454



BT-F430/2

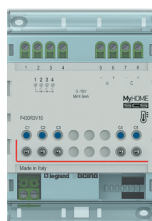

BT-F430R8



BT-F430V10

Pack	Cat.Nos	Display thermostats
1	7 521 31	<p>Flush-mounting thermostat with backlit display. Can be used to control the temperature of an individual zone, whether or not a temperature central unit is present. Features a temperature probe and an input for connecting a contact line (e.g. window contact). Can be used to manage different types of systems, and to adjust the fan speed when fan coils are used. Possibility of automatic operation (summer/winter), with compatible systems. Connection to SCS BUS – 2 modules</p> <p>Valena Life</p> <p>Valena Allure</p>
1	7 527 31	
1	BT-3454	<p>Probe without display</p> <p>Temperature probe in basic module with wired sensor To be associated with sensor Cat.No BT-3457</p>
1	BT-3457	<p>Accessory</p> <p>Temperature sensor to be associated with probe Cat.No BT-3454</p>

Pack	Cat.Nos	Actuators
1	BT-F430/2	<p>Actuator with 2 independent relays For single and double loads: 6 A resistive, 2 A motor driven valves and pumps Configuration-based logic relay interlock 2 DIN modules</p>
1	BT-F430/4	
1	BT-F430R8	<p>Actuator with 4 independent relays For single, double or mixed loads: 4 A resistive, 1 A motor driven valves, pumps and fan coils Configuration-based logic relay interlock 2 DIN modules</p>
1	BT-F430R3V10	
1	BT-F430V10	<p>Actuator with 8 independent relays For controlling on-off valves, motorised valves (open-close and three points), pumps and fan coils with 2 and 4 tubes; 4 A resistive, 1 A motor valves, pumps and fan-coils SCS-BUS connection 4 DIN modules</p> <p>Actuator with 3 independent relays and 2 x 0-10 V outputs For controlling fan coils with 2 and 4 tubes with proportional 0-10 V valves; 4 A resistive, 1 A fan coil SCS-BUS connection 4 DIN modules</p> <p>Actuator with 2 x 0-10 V outputs For controlling proportional 0-10 V valves SCS-BUS connection 2 DIN modules</p>

Valena™ Life/Allure - MyHOME_Up

Valena Life/Allure cover plates for MyHOME_Up mechanisms



7 553 20 + 7 540 01



7 554 23 + 7 543 01



7 553 22 + 7 541 31



7 554 33 + 7 543 91

Pack	Cat.Nos	Valena Life/Allure cover plates
		Regulation symbol, left-hand side mounting
		1 module
1	7 555 90	White Valena Life
1	7 555 91	Ivory Valena Life
1	7 555 92	Aluminium Valena Life
1	7 554 83	White Valena Allure
1	7 554 84	Ivory Valena Allure
1	7 554 93	Aluminium Valena Allure
		Regulation symbol, right-hand side mounting
		1 module
1	7 555 80	White Valena Life
1	7 555 81	Ivory Valena Life
1	7 555 82	Aluminium Valena Life
1	7 554 64	White Valena Allure
1	7 554 73	Ivory Valena Allure
1	7 554 74	Aluminium Valena Allure
		Regulation symbol
		2 modules
1	7 552 60	White Valena Life
1	7 552 61	Ivory Valena Life
1	7 552 62	Aluminium Valena Life
1	7 553 93	White Valena Allure
1	7 553 94	Ivory Valena Allure
1	7 554 03	Aluminium Valena Allure
		Light symbol, left-hand side mounting
		1 module
1	7 555 25	White Valena Life
1	7 555 26	Ivory Valena Life
1	7 555 27	Aluminium Valena Life
1	7 555 28	White Valena Allure
1	7 555 29	Ivory Valena Allure
1	7 555 30	Aluminium Valena Allure
		Light symbol, right-hand side mounting
		1 module
1	7 552 65	White Valena Life
1	7 552 66	Ivory Valena Life
1	7 552 67	Aluminium Valena Life
1	7 554 94	White Valena Allure
1	7 555 00	Ivory Valena Allure
1	7 555 24	Aluminium Valena Allure
		Light symbol
		2 modules
1	7 552 30	White Valena Life
1	7 552 31	Ivory Valena Life
1	7 552 32	Aluminium Valena Life
1	7 553 79	White Valena Allure
1	7 553 83	Ivory Valena Allure
1	7 553 84	Aluminium Valena Allure

Pack	Cat.Nos	Valena Life/Allure cover plates (continued)
		Dimmer symbol
		2 modules
1	7 553 20	White Valena Life
1	7 553 21	Ivory Valena Life
1	7 553 22	Aluminium Valena Life
1	7 554 23	White Valena Allure
1	7 554 24	Ivory Valena Allure
1	7 554 33	Aluminium Valena Allure
		Up/Down symbol either side
		1 module
1	7 554 00	White Valena Life
1	7 554 01	Ivory Valena Life
1	7 554 02	Aluminium Valena Life
1	7 554 53	White Valena Allure
1	7 554 54	Ivory Valena Allure
1	7 554 63	Aluminium Valena Allure
		Up/Down symbol
		2 modules
1	7 553 10	White Valena Life
1	7 553 11	Ivory Valena Life
1	7 553 12	Aluminium Valena Life
1	7 554 04	White Valena Allure
1	7 554 13	Ivory Valena Allure
1	7 554 14	Aluminium Valena Allure
		GEN marking
		2 modules
1	7 552 40	White Valena Life
1	7 552 41	Ivory Valena Life
1	7 552 42	Aluminium Valena Life
1	7 553 88	White Valena Allure
1	7 553 89	Ivory Valena Allure
1	7 553 91	Aluminium Valena Allure

Valena™ Life/Allure - MyHOME_Up

Valena Life/Allure cover plates for MyHOME_Up mechanisms (continued)



7 554 00 + 7 555 55
+ 7 540 01



7 554 53 + 7 555 47
+ 7 543 01



7 554 02 + 7 555 57
+ 7 541 31



7 554 63 + 7 555 49
+ 7 543 91

Pack	Cat.Nos	Valena Life/Allure cover plates (continued)
		GEN/ON/OFF marking, left-hand side mounting
		1 module
1	7 555 65	White Valena Life
1	7 555 66	Ivory Valena Life
1	7 555 67	Aluminium Valena Life
1	7 555 39	White Valena Allure
1	7 555 40	Ivory Valena Allure
1	7 555 46	Aluminium Valena Allure
		GEN/ON/OFF marking, right-hand side mounting
		1 module
1	7 555 55	White Valena Life
1	7 555 56	Ivory Valena Life
1	7 555 57	Aluminium Valena Life
1	7 555 36	White Valena Allure
1	7 555 37	Ivory Valena Allure
1	7 555 38	Aluminium Valena Allure
		GEN/ON/OFF marking
		2 modules
1	7 550 80	White Valena Life
1	7 550 81	Ivory Valena Life
1	7 550 82	Aluminium Valena Life
1	7 553 64	White Valena Allure
1	7 553 68	Ivory Valena Allure
1	7 553 69	Aluminium Valena Allure
		ON/OFF marking, left-hand side mounting
		1 module
1	7 555 85	White Valena Life
1	7 555 86	Ivory Valena Life
1	7 555 87	Aluminium Valena Life
1	7 555 58	White Valena Allure
1	7 555 59	Ivory Valena Allure
1	7 555 60	Aluminium Valena Allure
		ON/OFF marking, right-hand side mounting
		1 module
1	7 555 75	White Valena Life
1	7 555 76	Ivory Valena Life
1	7 555 77	Aluminium Valena Life
1	7 555 47	White Valena Allure
1	7 555 48	Ivory Valena Allure
1	7 555 49	Aluminium Valena Allure
		ON/OFF marking
		2 modules
1	7 551 70	White Valena Life
1	7 551 71	Ivory Valena Life
1	7 551 72	Aluminium Valena Life
1	7 553 73	White Valena Allure
1	7 553 74	Ivory Valena Allure
1	7 553 78	Aluminium Valena Allure

Pack	Cat.Nos	Valena Life/Allure cover plates (continued)
		Light and sound diffusion, right-hand side mounting
		1 module
1	7 555 95	White Valena Life
1	7 555 96	Ivory Valena Life
1	7 555 97	Aluminium Valena Life
1	7 555 68	White Valena Allure
1	7 555 69	Ivory Valena Allure
1	7 555 70	Aluminium Valena Allure
		Light and sound diffusion, left-hand side mounting
		1 module
1	7 553 13	White Valena Life
1	7 553 14	Ivory Valena Life
1	7 553 23	Aluminium Valena Life
1	7 555 73	White Valena Allure
1	7 555 74	Ivory Valena Allure
1	7 555 78	Aluminium Valena Allure
		Shutter STOP marking either side
		1 module
1	7 553 40	White Valena Life
1	7 553 41	Ivory Valena Life
1	7 553 42	Aluminium Valena Life
1	7 554 34	White Valena Allure
1	7 554 44	Ivory Valena Allure
1	7 554 43	Aluminium Valena Allure
		Without marking either side
		1 module
1	7 553 30	White Valena Life
1	7 553 31	Ivory Valena Life
1	7 553 32	Aluminium Valena Life
1	7 553 24	White Valena Allure
1	7 553 33	Ivory Valena Allure
1	7 553 34	Aluminium Valena Allure
		Without marking
		2 modules
1	7 550 60	White Valena Life
1	7 550 61	Ivory Valena Life
1	7 550 62	Aluminium Valena Life
1	7 553 43	White Valena Allure
1	7 553 44	Ivory Valena Allure
1	7 553 63	Aluminium Valena Allure

Valena™ Life/Allure - MyHOME_Up

cables and power supplies



BT-336904

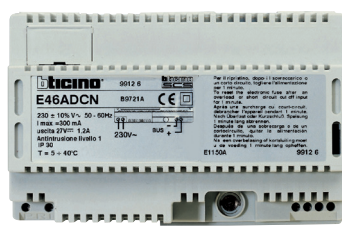

BT-E46ADCN



BT-E49



BT-3515

Pack	Cat.Nos	Connection cables - 2 wires
1	BT-L4669	Sheathed pair made up of 2 flexible wires with unshielded plaited sheath - insulation 300/500 V Conform to IEC 46-5 and IEC 20-20 Grey Length 100 m
1	BT-336905	Length 200 m. Low toxicity cable without halogen Ideal for application in environments where fire hazard safety is critical Length 500 m
1	BT-L4669/500	Length 500 m
1	BT-L4669KM1	Length 1000 m. Supplied on wooden reels
1	BT-336904	Specific connection cable Specific cable with 2 twisted conductors Can be installed in underground piping, in accordance with standards (CEI 20-13 and CEI 20-14) Ensures the best performance in video systems (higher distance between EP and Handset when compared with other cables) Length 200 m

Pack	Cat.Nos	Connection cables - 2 wires BUS power supplies
1	BT-E46ADCN	27 V_~ - 1.2 A Maximum consumption: 300 mA Maximum current supplied: 1.2 A 8 DIN modules 17.5 mm Input voltage: 230 VA output voltage 27 V _~
1	BT-E49	27 V_~ - 0.6 A Maximum current supplied: 0.6 A 2 DIN modules 17.5 mm Input voltage: 230 VA output voltage 27 V _~
10	BT-3515	BUS spare clamp Used to connect the various system components (controls, dimmers, etc) to the BUS line Male connector

System	Cable
	BT-L4669 - BT-L4669/500 BT-L4669KM1 - BT-336905
Automation	BT-336904
Energy Management/Consumption Display	BT-336904
Temperature control	BT-336904
Video door entry system	BT-336904

1: for systems underground cable sections



HEADQUARTERS

128, avenue de Lattre de Tassigny
87045 Limoges Cedex
France

Tel.: + 33 (0) 5 55 06 87 87

Fax: + 33 (0) 5 55 06 88 88

www.legrand.com

 www.facebook.com/legrand

 twitter.com/legrand_news