

EvoLine and EvoLine Plus wall-mounting cabinets

1. GENERAL CHARACTERISTICS

EvoLine wall mounted cabinets are an ideal solution in the offices and IT rooms for data cabling applications where the limited "U" height requirements and less devices are needed. EvoLine 19" cabinets are made of sheet metal and provide IP20 protection.

The main characteristics of the cabinets are;

- 4 mm thickness of glass, full-length smoked, shatterproof, tempered, secure
- Full glass door
- 450 mm and 600 mm depth. Double sectioned option (+160 mm) is available for cabinets with 450 mm depth
- Special structure allowing the adjustment of 19" device uprights throughout the depth
- Multiple cable entries: Top, bottom and rear

- Depending on the different customer needs there are two options available; cabinet with fixed side panels (EvoLine) and with openable side panels (EvoLine Plus - on demand)
- 65 kg. Load carrying capacity (for wall mounted installation)
- Color: RAL 7035 light grey (standard) and RAL 9005 black (on demand)

EvoLine

- 65 kg. Load carrying capacity (for wall mounted installation)
- Front door can be opened up to 120°
- 7U, 9U, 12U, 16U, 20U height options
- U marking device installation uprights
- Nut and washer connection for earthing

EvoLine Plus (on demand)

- Easy openable side panels
- all other parameters are the same as EvoLine

Load carrying capacity

65 kg if used as a wall mounted cabinet.

Top and bottom chassis

Top and bottom chassis which has a twisted monoblock design has a structure that will increase the resistance and strength of the cabinet.

Side panels

There are 2 options available; cabinet with fixed side panels (EvoLine) and with openable side panels (EvoLine Plus - on demand).

Front door and rear panel

According to EN 12150-1: 2000 standard, the front door has antistatic, secure and smoked glass (4mm thickness), decorative lane structure. The front door can be opened up to 120°, can be locked and unlocked with "O" type lock unit.

Cable entries

Pre-cut cable entries in 3 different point; top, bottom and rear.

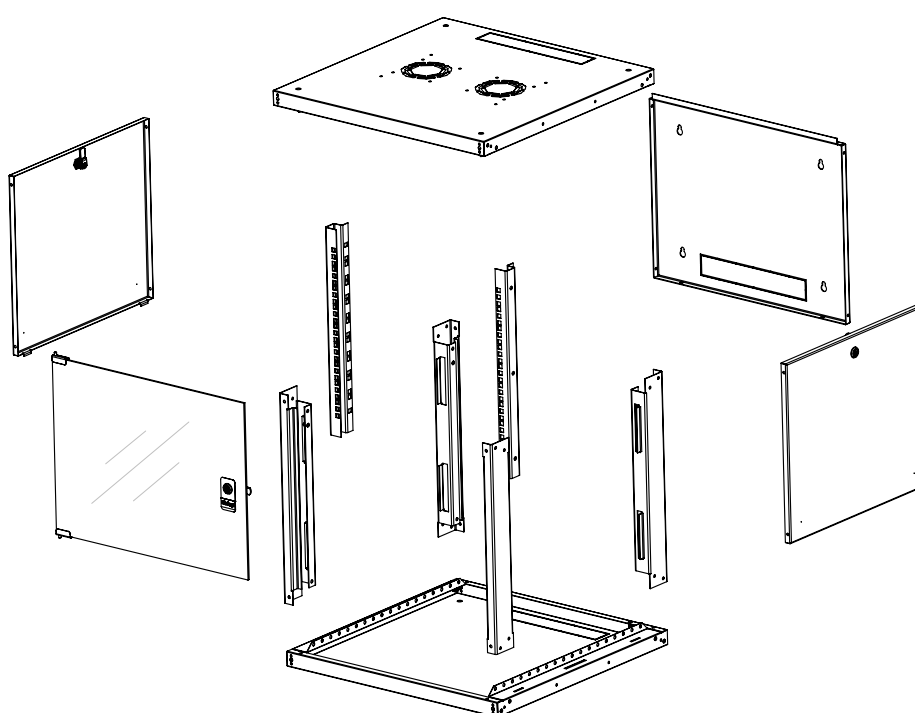

Exploded view

EvoLine and EvoLine Plus wall-mounting cabinets

2. TECHNICAL CHARACTERISTICS

2.1. IP PROTECTION

- IP 20 according to EN61587-1 / 6.4, IEC60529, IEC60917 and IEC60297 standards

2.2. MECHANICAL PERFORMANCE

- Load carrying capacity: 65 kg. (for wall mounted installation)

2.3. DESIGN

EVOLINE

- Standard front door: 4 mm thickness of glass, full-length smoked, shatterproof, tempered, secure
- 19" uprights: solid metal, 1,5 mm of thickness, 3 bending
- Side panels: Complete metal, 1 mm.
- Rear panel: 1,5 mm of thickness
- Door opening ability: 120°
- Color: RAL 7035 light grey (standard) and RAL 9005 black (on demand).

EVOLINE PLUS (on demand)

- Standard front door: 4 mm thickness of glass, full-length smoked, shatterproof, tempered, secure
- 19" uprights: solid metal, 1,5 mm of thickness, 3 bending
- Side panels: Complete metal, 0,8 mm.
- Rear panel: 1,5 mm of thickness
- Door opening ability: 120°
- Color: RAL 7035 light grey (standard) and RAL 9005 black (on demand).

2.4. CORROSION RESISTANCE

- ISO 9227 and ASTM B 117-85, IEC60917 and IEC60297

2.5. SURFACE COATING

- Electrostatic powder coated with surface treatment; 60-120 micron paint thickness
- Comply with ISO 9001, ISO 2178, ISO 2813, ISO 6272, ISO 8130-5, ISO 8130-3, RoHS standards.

3. STANDARDS

- ISO 9001:2015 Quality Management System
- ISO 14001:2015 Environmental Management System
- ISO 27001:2013 Information Security Management System
- OHSAS 18001:2014 Occupational Health and Safety Management System
- 19" device mounting uprights IEC 297-1
- EN 61587-1 Mechanical structures for electronic equipment.
- All cabinet sizes complies with IEC 297-2.

EVOLINE

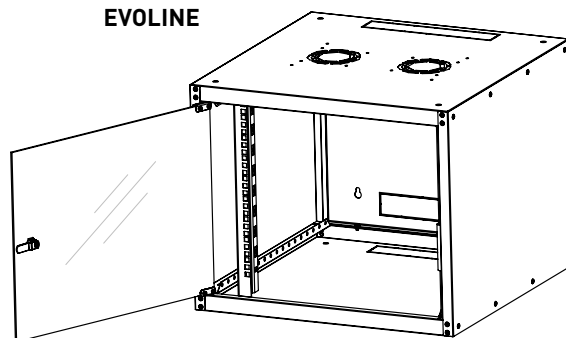

EVOLINE PLUS (on demand)

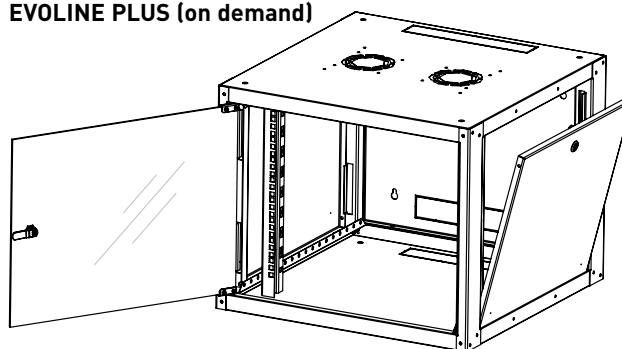

Isometric view

EvoLine and EvoLine Plus wall-mounting cabinets

4. DIMENSIONS

4.1. CABINET DIMENSIONS (mm)

| PRODUCT REFERENCE | RANGE | "U" HEIGHT | WIDTH | DEPTH | HEIGHT | HEIGHT WITH CASTERS | HEIGHT WITH LEVELLING FEET | "A" SIZE |
|-------------------|-----------------------------|------------|-------|-------|--------|---------------------|----------------------------|----------|
| EVO7U6045 | EVOLINE | 07 | 600 | 450 | 405 | 468 | 430 | 197 |
| EVO9U6045 | | 09 | 600 | 450 | 495 | 558 | 520 | 286 |
| EVO12U6045 | | 12 | 600 | 450 | 626 | 689 | 651 | 419 |
| EVO16U6045 | | 16 | 600 | 450 | 805 | 868 | 830 | 597 |
| EVO20U6045 | | 20 | 600 | 450 | 982 | 1045 | 1007 | 775 |
| | | | | | | | | |
| EVO7U6060 | | 07 | 600 | 600 | 405 | 468 | 430 | 197 |
| EVO9U6060 | | 09 | 600 | 600 | 495 | 558 | 520 | 286 |
| EVO12U6060 | | 12 | 600 | 600 | 626 | 689 | 651 | 419 |
| EVO16U6060 | | 16 | 600 | 600 | 805 | 868 | 830 | 597 |
| EVO20U6060 | | 20 | 600 | 600 | 982 | 1045 | 1007 | 775 |
| | EVOLINE PLUS (on demand) | | | | | | | |
| EVO7U6045P | | 07 | 600 | 450 | 405 | 468 | 430 | 197 |
| EVO9U6045P | | 09 | 600 | 450 | 495 | 558 | 520 | 286 |
| EVO12U6045P | | 12 | 600 | 450 | 626 | 689 | 651 | 419 |
| EVO16U6045P | | 16 | 600 | 450 | 805 | 868 | 830 | 597 |
| EVO20U6045P | | 20 | 600 | 450 | 982 | 1045 | 1007 | 775 |
| | | | | | | | | |
| EVO7U6060P | | 07 | 600 | 600 | 405 | 468 | 430 | 197 |
| EVO9U6060P | | 09 | 600 | 600 | 495 | 558 | 520 | 286 |
| EVO12U6060P | | 12 | 600 | 600 | 626 | 689 | 651 | 419 |
| EVO16U6060P | | 16 | 600 | 600 | 805 | 868 | 830 | 597 |
| EVO20U6060P | | 20 | 600 | 600 | 982 | 1045 | 1007 | 775 |

EvoLine and EvoLine Plus wall-mounting cabinets

5. TECHNICAL DRAWINGS (mm)

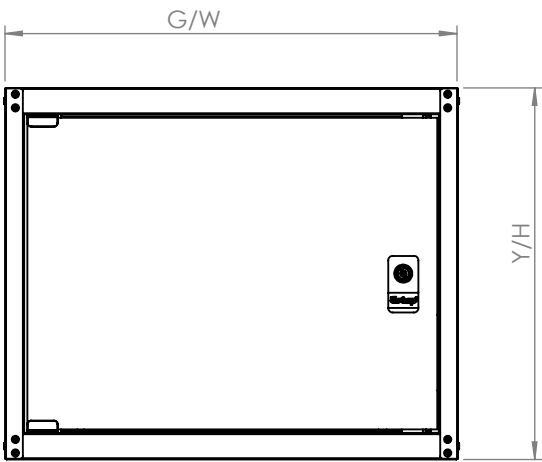

Front view

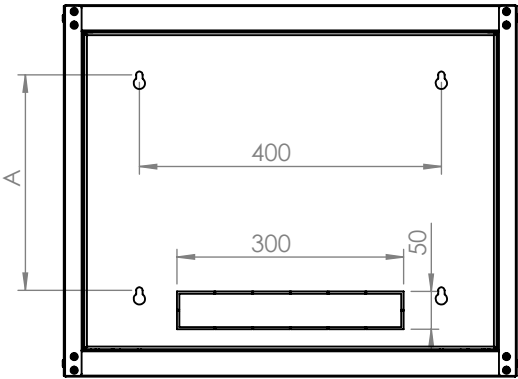

Side view

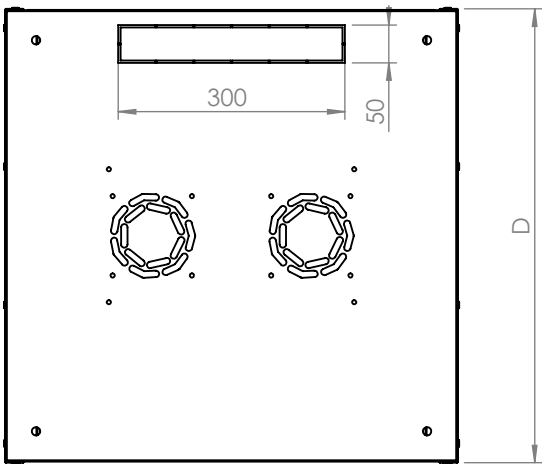

Top view

EvoLine wall-mounting cabinets

5. TECHNICAL DRAWINGS (mm)

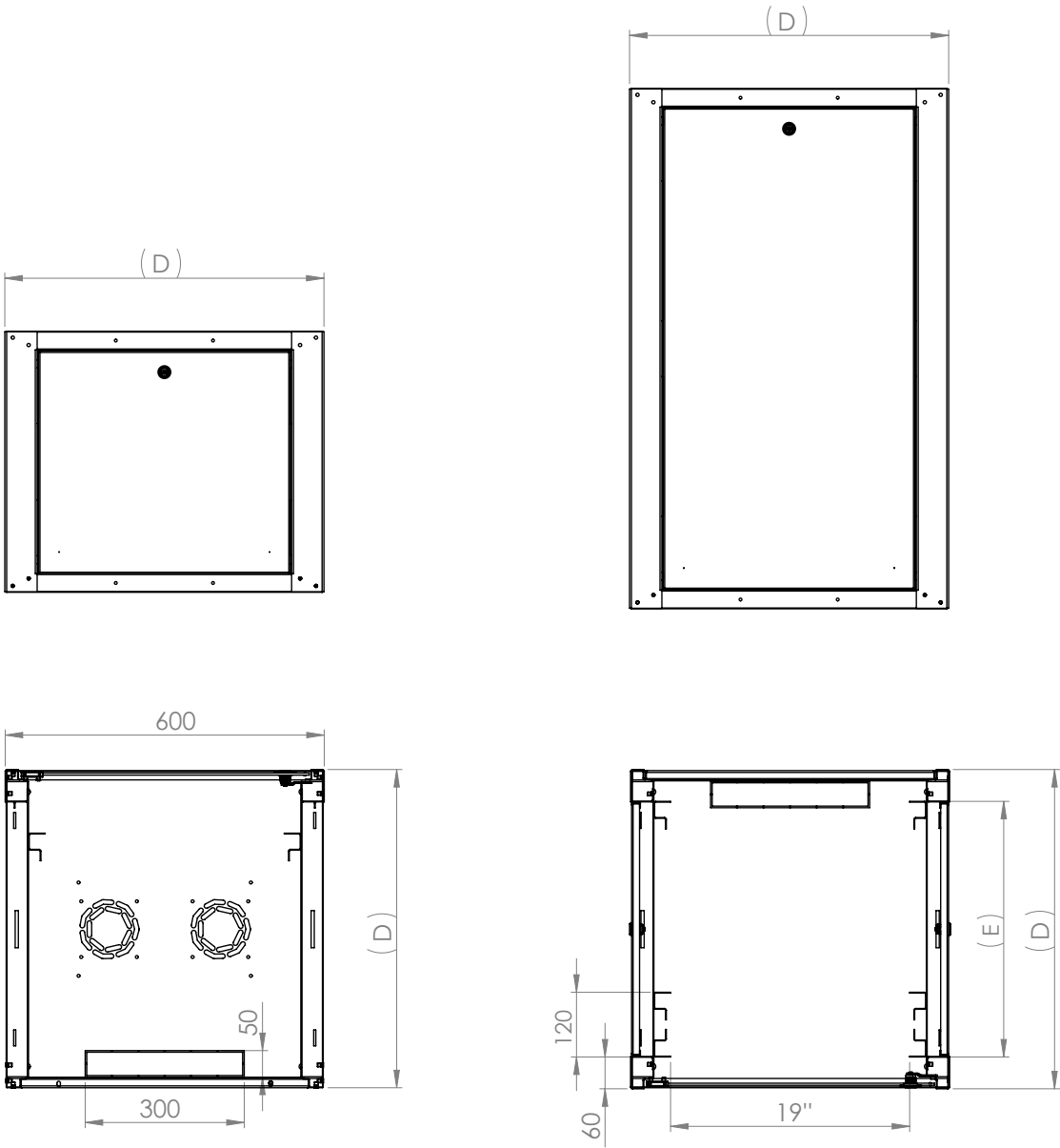

| D (mm) | E (mm) |
|--------|--------|
| 450 | 330 |
| 600 | 482 |

EvoLine Plus wall-mounting cabinets

5. TECHNICAL DRAWINGS (mm)

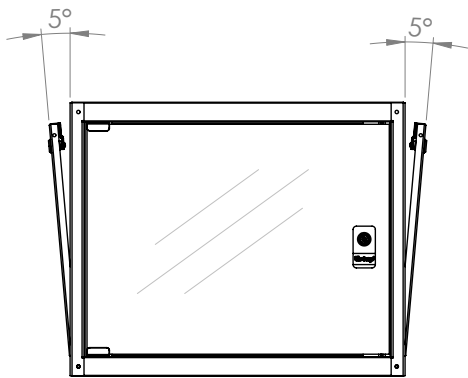
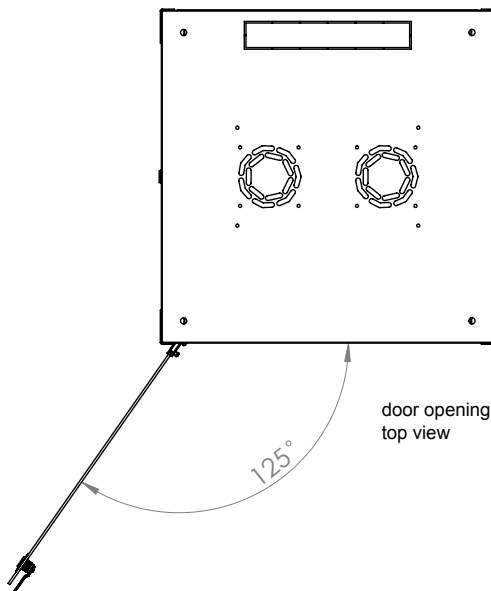

EvoLine and EvoLine Plus wall-mounting cabinets

5. TECHNICAL DRAWINGS (mm)

Double sectioned

For the EVOLINE and EVOLINE PLUS (on demand) series with a depth of 450 mm, it has a monoblock wall frame option of D= 160 mm welding which allows double sectioned application.
With increased depth, it offers rear access to the devices.

| PRODUCT REFERENCE | WxD (mm) |
|-------------------|-----------|
| EPB7U | 600 x 160 |
| EPB9U | 600 x 160 |
| EPB12U | 600 x 160 |
| EPB16U | 600 x 160 |
| EPB20U | 600 x 160 |

EVOLINE

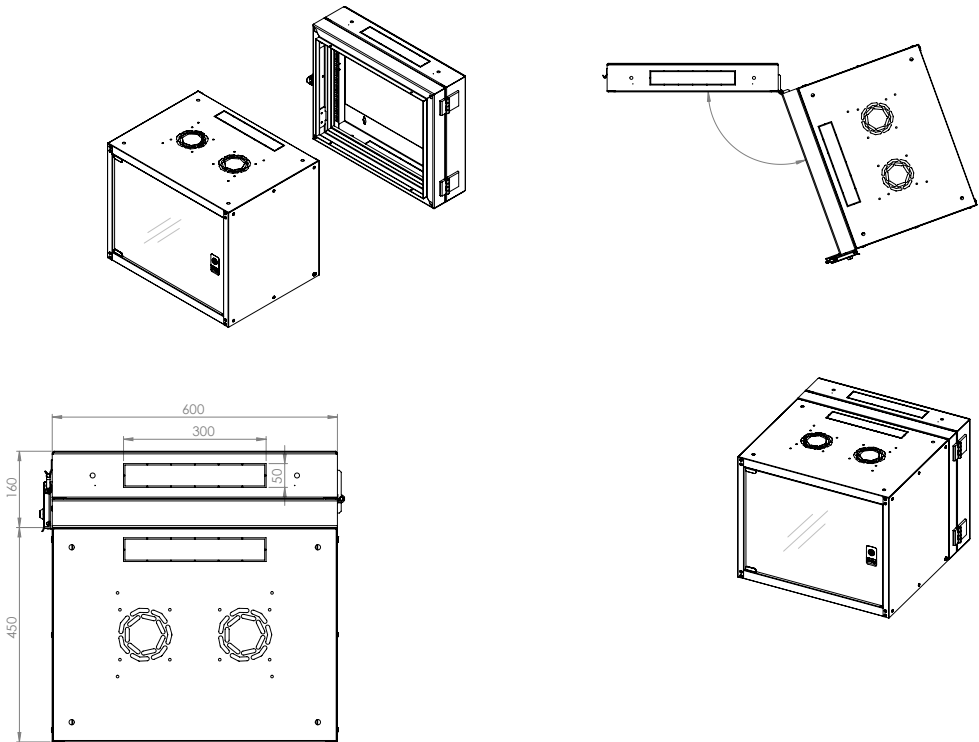

EVOLINE PLUS (on demand)

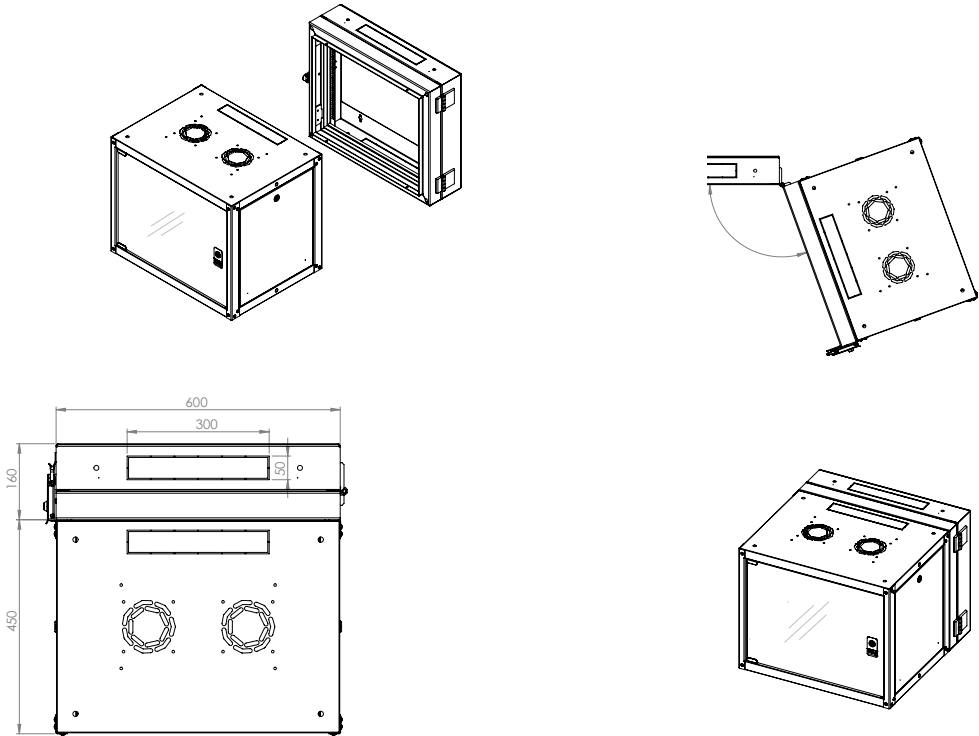

EvoLine and EvoLine Plus wall-mounting cabinets

6. ACCESSORIES

6.1. CASTORS AND LEVELLING FEET

- Castors rotate and can move any direction
- 2 ea. front are lockable
- Load capacity per castor:
Fixed: 50 kg
Moving: 25kg
- Load capacity per levelling feet: 250 kg.
- Levelling feet: Possible to adjust height of the feet from the floor.

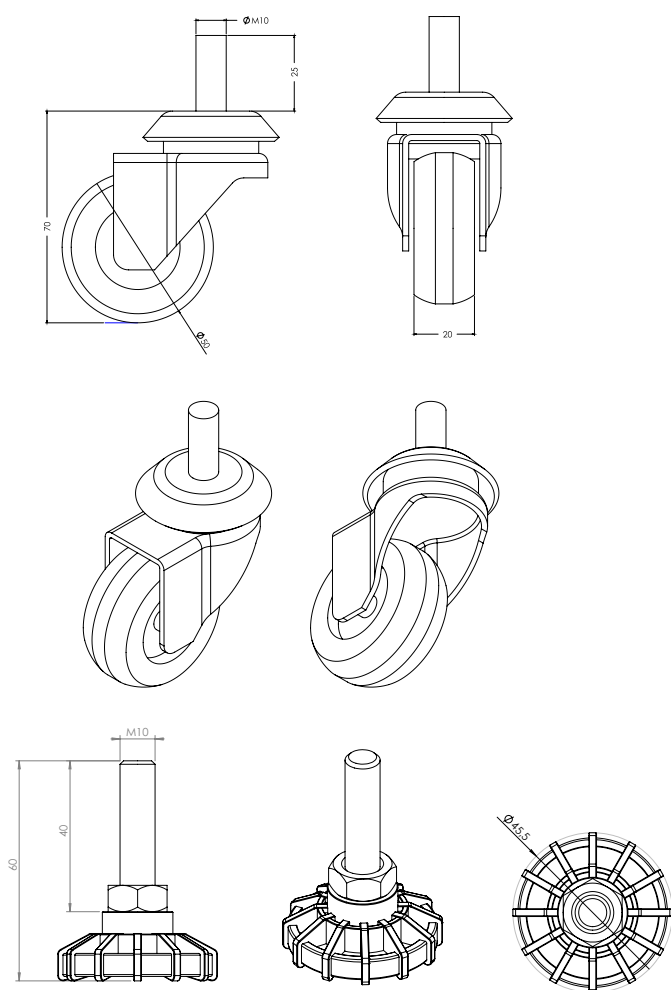

| PRODUCT REFERENCE | | 600x450 mm | 600x600 mm | 600x450 mm +160 mm |
|-------------------|----------------|------------|------------|--------------------|
| ELEVL | LEVELLING FEET | x | x | x |
| ECSTW | CASTORS | x | x | x |

6.2. 19" BACK 19" RAILS

- Easy to install
- Easy to move
- "U" marking device installation uprights
- Material: Galvanized coated sheet steel

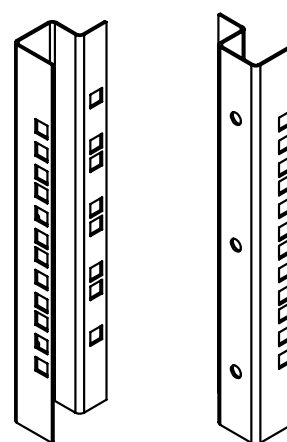

| PRODUCT REFERENCE | "U" HEIGHT | 600x450 mm | 600x600 mm | 600x450 mm +160 mm |
|-------------------|------------|------------|------------|--------------------|
| EBR7U | 07 | x | x | x |
| EBR9U | 09 | x | x | x |
| EBR12U | 12 | x | x | x |
| EBR16U | 16 | x | x | x |
| EBR20U | 20 | x | x | x |

EvoLine and EvoLine Plus wall-mounting cabinets

6.3. SHELVES

6.3.1. RACK MOUNT SHELVES

- 2 point, fixing directly to 19" front mounting angles
- Vented
- Material: sheet steel
- Load carrying capacity: 50 kg
- Colour: RAL 9005 black

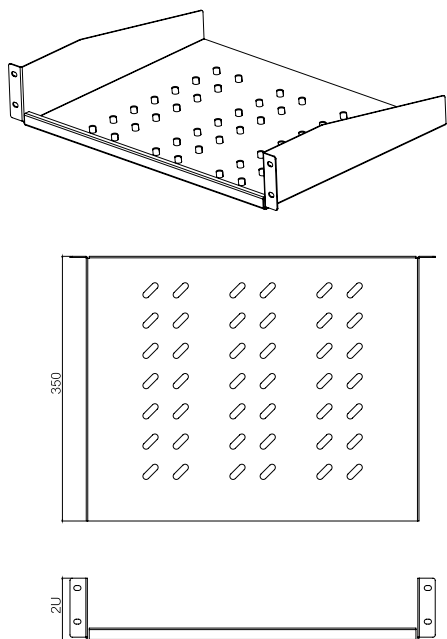

6.4. VENTILATION UNIT

- Thermostat-air temperature controller
- Range: -10-+85 degree, below set point fan does not activate
- Above set point fan units start ventilation. Complete with inner wiring.
- Noise: 34-38 db
- A fan provides 2,33 / m³. Air removal,
- CFM: 45-56
- Colour: RAL 7035 light grey

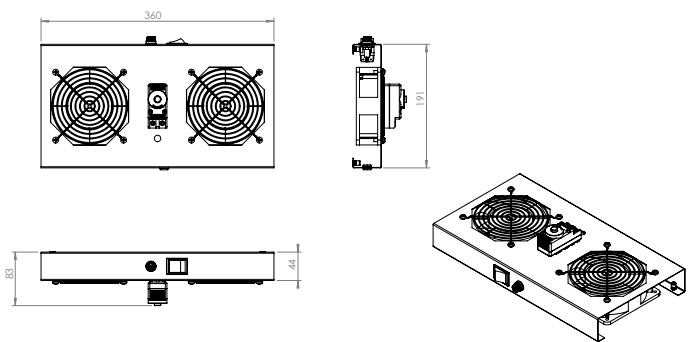

| PRODUCT REFERENCE | DESCRIPTION | WxDxH (mm) | 600x450 mm | 600x600 mm | 600x450 mm +160 mm |
|-------------------|----------------------------|------------|------------|------------|--------------------|
| EC2VW | 2 fan + thermostat control | 360x191x83 | X | X | X |

| PRODUCT REFERENCE | WxDxH (mm) | 600x450 mm | 600x600 mm | 600x450 mm +160 mm |
|-------------------|------------|------------|------------|--------------------|
| E2S1U25 | 483x250x44 | X | X | X |
| E2S1U40 | 483x400x44 | | X | |

EvoLine and EvoLine Plus wall-mounting cabinets

6.8. BLANKING PANELS

Blank panels are used to close empty positions in the cabinet.

- 19"
- Material: Sheet steel
- Colour: RAL 9005 black

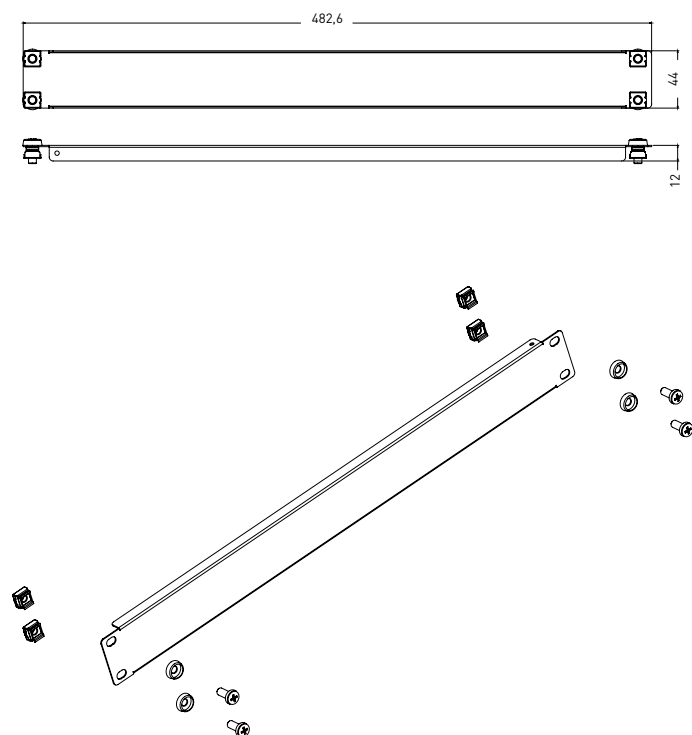

| PRODUCT REFERENCE | HEIGHT | WxDxH (mm) |
|-------------------|--------|------------|
| EBPN1 | 1U | 483x80x44 |
| EBPN2 | 2U | 483x80x88 |
| EBPN3 | 3U | 483x80x132 |
| EBPN4 | 4U | 483x80x176 |
| EBPN5 | 5U | 483x80x220 |
| EBPN6 | 6U | 483x80x264 |

6.5. HORIZONTAL CABLE MANAGER

- The range is suitable for all 19" applications.
- Sheet steel, easy to install and mount.
- Rings: 5 ea. cable hook
- Colour: RAL 9005 black

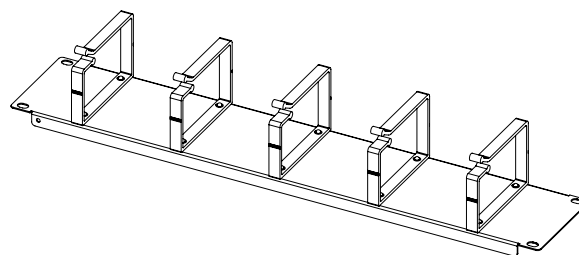

Standard organizer

| PRODUCT REFERENCE | WxDxH (mm) | 600x450 mm | 600x600 mm | 600x450 mm +160 mm |
|-------------------|------------|------------|------------|--------------------|
| EHPM1UM | 483x80x44 | X | X | X |
| EHPM2UM | 483x80x88 | X | X | X |
| EHPM1UP | 483x80x44 | X | X | X |

EvoLine and EvoLine Plus wall-mounting cabinets

6.6. LIGHTING UNIT LED

- Different dimensions.
- 2 different connection apparatus to connect units.
- Effective and powerful lightning.
- Light and strong structure.
- Economical solution.

Dimension : L500/L800/L1000*25*13,5 mm
 Input : DC12V
 Emitting Colour : White (5000-6500K)
 Ra : 70-80
 Power : 5W / 8,5W / 10,5W
 Material : Alu+Glass
 Luminous Flux : 360-450lm
 Adaptor Capacity : 36W
 Other Length : 300 mm, 500 mm, 800 mm, 1000 mm

Technical details

Light Source : LED
 Item Type : Cabinet Lights
 LED Light Source : SMD 3014
 Install Style : Wall Mounted
 Shade Type : PC
 Shade Direction : Down
 Input Voltage(V) : DC12V
 Lamp Power(W) : 5W / 8,5W / 10,5W
 Lamp Luminous
 Flux(lm) : 350-450LM
 Lamp Luminous
 Efficiency(lm/w) : 85
 CRI (Ra>) : 75
 Color Temperature
 (CCT) : Pure White
 Certification : CE, EMC, RoHS, UL
 Emitting Color : White
 Color : Cold White
 Life : 30,000h
 Material : PC+Alu
 IP grade : IP 20

| PRODUCT REFERENCE | WxDxH (mm) | 600x450 mm | 600x600 mm | 600x450 mm +160 mm |
|----------------------|---------------|------------|------------|-----------------------|
| ELF300M | 300x30x10 | X | X | X |

6.7. BRUSH ENTRY

To cover pre-cut cable entries.

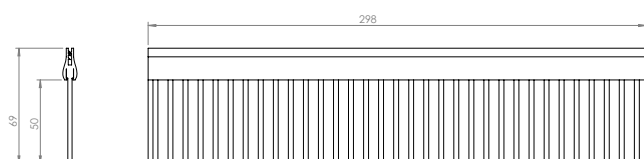

| REFERENCE | EBRSH |
|-----------|-------|
|-----------|-------|

EvoLine and EvoLine Plus wall-mounting cabinets

7. TECHNICAL CHARACTERISTICS

7.1. TESTS AND COMPLIED STANDARDS

Environment

EN61587-1 / 4.2, IEC60068-2-1, IEC60068-2-2, IEC60068-2-30, IEC60917 and IEC60297

Industrial Environment

EN61587-1 / 4.3, IEC60068-2-42, IEC60068-2-43, IEC60068-2-49, IEC60068-2-1, IEC60917 and IEC60297

Statical mechanical structure load test

EN61587-1 / 5.2.1, IEC60917 and IEC60297

Statical mechanical structure stability

EN61587-1 / 5.2.2, IEC60917 and IEC60297

Dynamic load, vibration and mechanical stroke

EN61587-1 / 5.3.1, EN61587- / 5.3.3, IEC60917, C60297, IEC62208

Grounding continuity

EN61587-1 / 6.2, IEC60917, IEC60297 and IEC 61010-1

Fire and flame resistance

EN61587-1 / 6.3, IEC60917 and IEC60297

Corrosion

ISO9227 and ASTM B 117-85, IEC60917 and IEC60297

IP protection degree

IP20 according to EN61587-1 / 6.4, IEC60529, IEC60917 and IEC60297

PURCHASED PRODUCT CERTIFICATION

Sheet steel

DIN EN 10130 – 99 Ereğli DC-01 6112, 7122, RoHS

Electrostatic powder coating

ISO 9001, ISO 2178, ISO 2813, I SO 6272, ISO 8130-5, ISO 8130-3, RoHS

Fan

ISO 9001, CE (89/336/EEC EMC, 73/23/EEC LVD), RoHS

Glass

ISO 9001, EN 12150 – 1: 2000 tempered and secure

Fixings

DIN 7985, DIN 965, DIN 7981, DIN 934, DIN 985, DIN 933, RoHS

Casters

TS EN 12530, TS EN 12532, RoHS

Lock

DIN 1743, DIN 53571, RoHS

7.2. KEY FEATURES

Load carrying capacity; load carrying capacity is 65 kg.

Top and bottom chassis; Top and bottom chassis which has a twisted monoblock design has a structure that will increase the resistance and strength of the cabinet. The perforated top panel consists of special vent holes for ventilation and the fan module system allows for installation of a maximum of 2 fans. In the EvoLine version, each side panel is fixed with M5 rivets to the top and bottom chassis.

The 450 mm depth EvoLine and EvoLine Plus series have a D = 160 mm, welded, wallmounted monoblock frame option which allows double sectioned cabinet application. Thus, provides the possibility of increasing depth and offers access to the rear of the devices also.

Front and rear covers; According to EN 12150-1: 2000 standard, the front door has an antistatic, secure and smoked glass (4mm thickness), decorative lane structure. The front door can be opened up to 120°, can be locked and unlocked with "O" type lock unit.

The structure of the rear panel can be mechanically locked from the inside with a standard 2 screws, allowing the back panel to be used like a wall bracket.

Side panels; There are 2 options available; cabinet with fixed side panels and cabinet with openable side panels. In the fixed version of the side panels, the panels have a fixed rivet.

Cable entries; Brushed cable entries which are pre-cut on the top, bottom and rear side of the cabinet with the dimension of 300 mm x 50 mm.

Dimensions; Complies with IEC 60297 standard. Cabinets are (7U/9U/12U/16U/20U) height, 600 mm. width and 450 mm or 600 mm. depth.

Delivery option; Both assembled and flatpack options are available in the version with side panels openable (EVOLINE PLUS).

19" uprights; The 19" (in.) "U" marked device mounting bracket (2 in front) is a part of the cabinet interior configuration.

ACCESSORIES

Fan System; The setting range is between 0-35 °C with digital, analog or ON/OFF switch with 1 or 2 pieces fan controlled thermostat units.

It is suitable for installation inside the cabinet with electric cable and internal wiring. Every fan at 50 Hz max. have a noise level of 38 dB and 53 CFM airflow. It has a CE certificate.

Castors and/or leveling feet; The wheels are movable in every direction and the front wheels have a lockable structure. The load carrying capacity of each wheel and each leveling feet is 250 kg.

Lighting fixture; 19", 1U, with ON/OFF switch, 220 Vac, automatic door with ON/OFF switch or LED with sensor.

Grounding continuity; Grounding continuity in the cabinet complies with IEC 61010-1 standard. For all doors, these grounding cable connections are made with bolts and nuts.

Grounding continuity between the 19" movable mounting profiles and the main body is provided with the toothed nuts and screws.

The Cabinet complies with EN 61587-1, IEC 60917, IEC 60297 standards, and are RoHS compliant, GOST and TSE certified. Cabinets are manufactured at our factory which has ISO 9001 Quality Management System and ISO 14001: 2004 Environmental Management System showing our commitment to the environment.